

Catalogue number: **EUR**□□-□□□□□□□□



IP42 Surface and Flush mounted Load Centres



Load Centre  
Transparent cover



Load Centre  
White Cover



Metal Load Centre Base

### IP42 Surface and Flush mounted Load Centre

- AS/NZS 61439-3
- Enclosure Material:
  - Base; Plastic or Metal
  - Cover; Transparent or White Plastic
- IP42 Rated Load Centres
- Wide range of Enclosure heights
- Rigid Construction
- Complete with DIN rail, mounting brackets, Earth and Neutral bars
- Neutral Bars; 1 Unprotected and 2 Protected as Main switch

EUR-		□□-□□□□□□□□
No. of Pole		Type of Load Centre
8	8 Poles	-ST E&N Transparent Cover, Surface Mount Plastic Load Centre
12	12 Poles	-FT E&N Transparent Cover, Flush Mount Plastic Load Centre
18	18 Poles	-SW E&N White Cover, Surface Mount Plastic Load Centre
24	24 Poles	-FW E&N White Cover, Flush Mount Plastic Load Centre
36	36 Poles	-FW-M E&N White Cover, Flush Mount Metal Base Load Centre
		-FT-M E&N Transparent Cover, Flush Mount Metal Base Load Centre

### Properties

Properties	
Manufacturer	Eureka
Product Range	Eureka Load Centres
IP rating	IP42
Enclosure Material	White Cover Plastic Load Centre Transparent Cover Plastic Load Centre White Cover Load Centre, Metal Base Transparent Cover Plastic Load Centre, Metal Base
Mounting Type	Surface or Flush Mounting
No. of Poles	8, 12, 18, 24 and 36
Neutral	1 Unprotected and 2 Protected Neutral Bars
Cable Entry	Top, Bottom and Rear Entry



Catalogue number: **EUR-MDB**□□□□□□□□

Eureka MDB IP42/IP56 Distribution Board 750-1800mm



### Dimensions for Surface Mount Load Centres

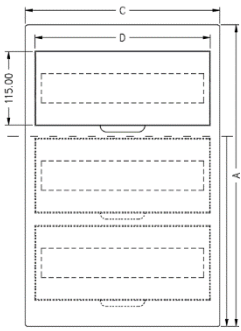

FRONT VIEW

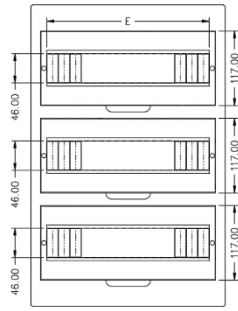

FRONT VIEW  
FRONT DOOR-COVER NOT SHOWN

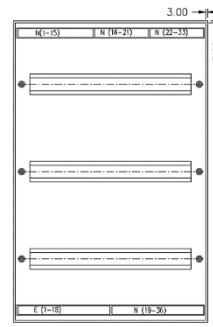

FRONT VIEW  
FRONT COVER NOT SHOWN

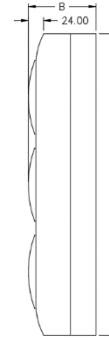

SIDE VIEW



TOP/BOTTOM VIEW

Part No.	Part No.	A	B	C	D	E
EUR8-SW E&N	EUR8-ST E&N	200	98	184	164	146
EUR12-SW E&N	EUR12-ST E&N	200	98	256	236	218
EUR18-SW E&N	EUR18-ST E&N	200	100	364	344	326
EUR24-SW E&N	EUR24-ST E&N	325	102	270	238	220
EUR36-SW E&N	EUR36-ST E&N	473	106	305	273	225

### Dimensions for Flush Mount Load Centres

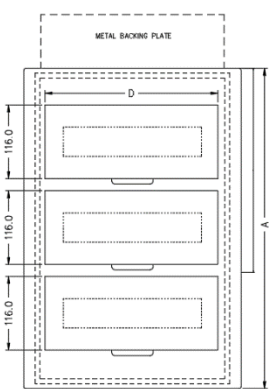

FRONT VIEW

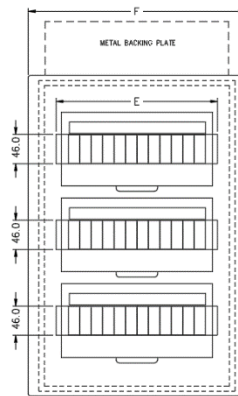

FRONT VIEW  
FRONT DOORS NOT SHOWN

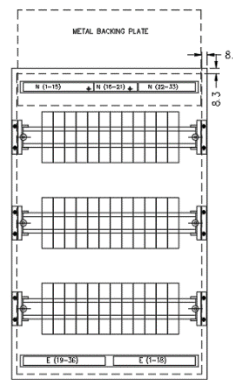

FRONT VIEW  
FRONT COVER NOT SHOWN

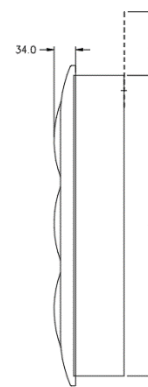

SIDE VIEW

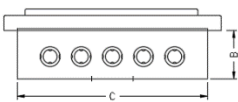

TOP/BOTTOM VIEW

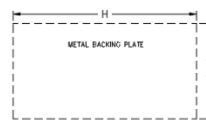

METAL BACK PLATE

Part No.	Part No.	A	B	C	D	E	F	G	H
EUR12-FW E&N	EUR12-FT E&N	247	65	253	237	218	305	190	255
EUR12-FW-ME&N	EUR12-FT-ME&N								
EUR18-FW E&N	EUR18-FT E&N	268	75/65	362	345	325	412	218	360
EUR18-FW-ME&N	EUR18-FT-ME&N								
EUR24-FW E&N	EUR24-FT E&N	360	75/65	254	238	218	305	310	251
EUR24-FW-ME&N	EUR24-FT-ME&N								
EUR36-FW E&N	EUR36-FT E&N	502	75/65	290	272	254	342	473	288.5
EUR36-FW-ME&N	EUR36-FT-ME&N								

